

Sir William Smith Road,
Kirkton Industrial Estate,
Arbroath, Angus, Scotland
U.K. DD11 3RD
Tel. : +44 (0) 1241 877776
Fax : +44 (0) 1241 871037
E-mail: PioneerOilTools@btinternet.com



PIONEER FISHING MAGNETS M SERIES

The PIONEER range of Fishing Magnets provides a simple and effective means of retrieving small objects from the bottom of bore holes, assuming that they have magnetic attraction.

These objects, liable to cause damage to expensive drill bits are commonly cones, cutters, mill cuttings, bearings, pins or even hand tools such as hammers or spanners.

Pioneer Fishing Magnets may run on either wireline, for which a wireline adaptor is available, or pipe. Running on pipe is preferred in terms of efficiency as the circulation holes in the magnet allow the fluid to loosen the object and wash out heavy cuttings. Discontinue circulation when the object has been contacted.

The Fishing Magnet is supplied with a Flush Type Guide as standard. Mill Guides and Lipped Guides are available as optional extras.

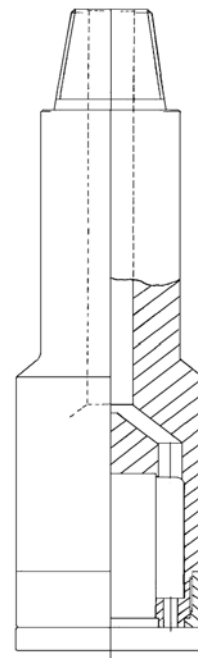

**Item 5
Flush Guide**

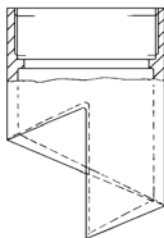

**Item 20
Lipped Guide**

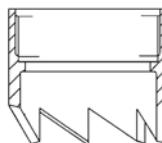

**Item 21
Mill Guide**



**Item 22
Wire Line
Adaptor**

“QUALITY + DELIVERY IS OUR PRIORITY”

HOW TO ORDER

Specify :-

1. Name & Number of Assembly.
2. Size – O.D.
3. Top Connection, if other than standard.

Recommended Accessories :-

- 1 off Lipped Guide
- 1 off Mill Guide

To order Wireline Adaptor specify Assembly number plus item no. (22) and top connection required. To order Lipped or Mill Guides, specify Assembly Number plus item no. (20 or 21)

Hole Size	From To	3.1/4" – 4.1/8"	4" – 4.1/4"	4.1/4" – 4.1/2"	4.1/2" – 5"	5.1/8" – 5.1/2"	5.5/8" – 6"
Size – O.D.		3"	3.1/4"	3.1/2"	4"	4.1/2"	5"
Top Connection - Pin		2.3/8" TBG	2.3/8" TBG	2.3/8" Reg.	2.3/8" Reg.	2.7/8" Reg.	2.7/8" Reg.
Approx. Pull in lbs.		190	190	260	340	430	520
Complete Assembly	Part No.	M 0300	M 0325	M 0350	M 0400	M 0450	M 0500
	Weight	20	25	27.1/2	43	67	80

Hole Size	From To	6.1/8" – 6.1/2"	6.1/8"- 6.1/2"	6.5/8" – 7.1/2"	7.5/8" – 8.1/2"	8.5/8" - 9.3/4"	9.7/8" – 11.5/8"
Size – O.D.		5.1/2"	5.3/4"	6"	7"	8"	9"
Top Connection - Pin		3.1/2" Reg.	3.1/2" Reg.	3.1/2" Reg.	4.1/2" Reg.	4.1/2" Reg.	4.1/2" Reg.
Approx. Pull in lbs.		630	630	750	1000	1300	1400
Complete Assembly	Part No.	M 0550	M 0575	M 0600	M 0700	M 0800	M 0900
	Weight	95	106	120	162	205	335

Hole Size	From To	10.1/2" – 11.7/8"	11.3/4"- 13"	12.1/4" – 14"	15"	17"	20"
Size – O.D.		10"	10.1/2"	11.1/2"	14"	16"	19"
Top Connection - Pin		6.5/8" Reg.	6.5/8" Reg.	6.5/8" Reg.	6.5/8" Reg.	6.5/8" Reg.	7.5/8" Reg.
Approx. Pull in lbs.		1800	1800	2200	3300	4300	6000
Complete Assembly	Part No.	M 1000	M 1050	M 1150	M 1400	M 1600	M 1900
	Weight	390	431	512	770	1200	1700

**As the policy of Pioneer Oil Tools is one of continual products improvement,
we reserve the right to change designs or specifications without notice.**